

616 GIBSON CIR SW, VIENNA, VA 22180

LOT AC/SF: 0.27 / 11,669
TOTAL FINISHED SF: 6,845



WWW.616GIBSONCIRCLESW.COM



\$ 2,579,888

616 GIBSON CIR SW, VIENNA, VA 22180

LOT AC/SF: 0.27 / 11,669
TOTAL FINISHED SF: 6,845



WWW.616GIBSONCIRCLESW.COM



1ST FLOOR

TOTAL FINISHED SPACE: 2018 SF
DECK: 18'X15'
STOOD: 87 SF
GARAGE: 436 SF
DRIVEWAY: 436 SF

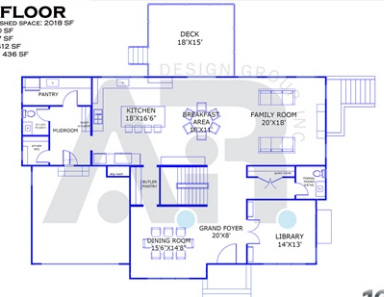

WWW.616GIBSONCIRCLESW.COM



2ND FLOOR

TOTAL FINISHED SPACE: 2407 SF
BALCONY: 71 SF
TWO STORERS: 74 SF



WWW.616GIBSONCIRCLESW.COM



LOFT

TOTAL FINISHED SPACE: 433 SF (18% OF 2ND FL)
PLATFORM EQUIPMENT: 99 SF
PATIO: 299 SF

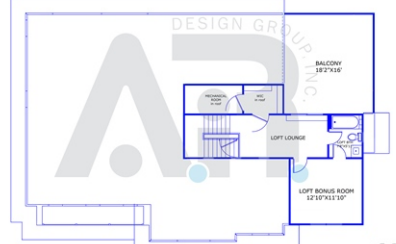

WWW.616GIBSONCIRCLESW.COM



616 Gibson Circle SW, Vienna, VA 22180

- » Beds: 6 | Baths: 6 Full, 2 Half
- » Single Family | 6,845 ft² | Lot: 11,669 ft²
- » More Info: 616GibsonCircleSW.com



Red Door Metro
of Keller Williams Realty
(703) 906-2881 (Main)
1 (844) 596-3876 (Toll Free)
clientcare@reddoormetro.com
<http://www.reddoormetro.com>



Red Door Metro
1775 Tysons Blvd
Suite 1450
McLean, VA 22102
(703) 564-4000

Experience a lifestyle of tranquility and sophistication in a home that truly stands apart. Nestled in the exclusive cul-de-sac of 616 Gibson Circle, this magnificent .27-acre property, crafted by AR Design Group, offers 6,845 sq ft of exceptional luxury and thoughtful design.

The upper level features a custom-built family lounge and four sun-drenched bedrooms, each complete with a walk-in closet and en-suite bath. Indulge in your private retreat within the master suite, boasting a spa-inspired bathroom and oversized windows that provide picturesque views of your secluded backyard.

The 3rd-level loft offers additional living space with a private bedroom, full bath, and lounge area that opens up to an expansive 300 sq ft rooftop terrace—ideal for morning coffee or evening stargazing.

On the lower level, you'll find a state-of-the-art gym, a spacious recreation room, an entertainment area, and a second office or full bedroom suite.

